

PTFE Reactor Lids

Quick and easy to set up & fully customisable

With a standard working temperature range of $-200\text{ }^{\circ}\text{C}$ to $+260\text{ }^{\circ}\text{C}$ and a high level of resistance to many chemicals, using a PTFE reactor lid allows great flexibility for your setup.

Whilst these particular lids are factory assembled, arriving complete and ready for you to use, scientists can easily reconfigure the layout and even replace any of the taper joints featured.



To fit 60 mm ID Schott type flanges:

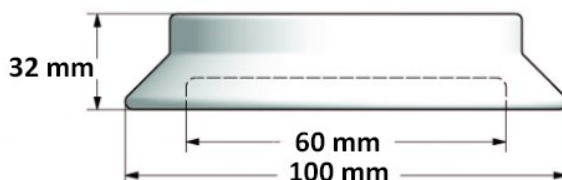

60 mm Diameter Lid		- option 1	
Base	Port Type	Taper Joint	Port Size
Centre Port	Vertical	24/-	1/2" NPT
Side Port 1	10° x 10° Compound Angle	14/-	1/2" NPT
Side Port 2	10° x 10° Compound Angle	14/-	1/2" NPT
Side Port 3	10° x 10° Compound Angle	14/-	1/2" NPT
60 mm Diameter Lid		- option 2	
Base	Port Type	Taper Joint	Port Size
Centre Port	Vertical	24/-	1/2" NPT
Side Port 1	10° x 10° Compound Angle	19/-	1/2" NPT
Side Port 2	10° x 10° Compound Angle	19/-	1/2" NPT
Side Port 3	10° x 10° Compound Angle	19/-	1/2" NPT

Contact us to discuss your requirements

To fit 100 mm ID Schott type flanges:

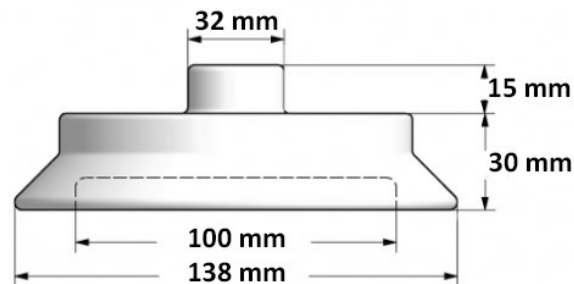

100 mm Diameter Lid - option 1

Base	Port Type	Taper Joint	Port Size
Centre Port	Vertical	24/-	3/4" NPT
Side Port 1	Vertical	24/-	3/4" NPT
Side Port 2	10° Angle	24/-	3/4" NPT
Side Port 3	10° Angle	19/-	3/4" NPT
Side Port 4	10° x 10° Compound Angle	24/-	3/4" NPT

100 mm Diameter Lid - option 2

Base	Port Type	taper Joint	Port Size
Centre Port	Vertical	29/-	3/4" NPT
Side Port 1	Vertical	24/-	3/4" NPT
Side Port 2	10° Angle	19/-	3/4" NPT
Side Port 3	10° Angle	24/-	3/4" NPT
Side Port 4	10° x 10° Compound Angle	29/-	3/4" NPT

Contact us to discuss your requirements

To fit 150 mm ID Schott type flanges:

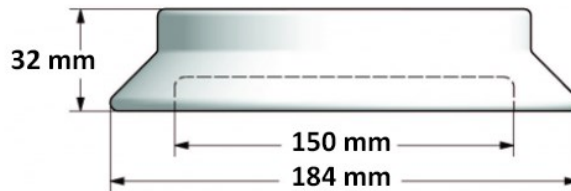

150 mm Diameter Lid - option 1

Base	Port Type	Taper Joint	Port Size
Centre Port	Vertical	29/-	1" NPT
Side Port 1	Vertical	24/-	1" NPT
Side Port 2	Vertical	29/-	1" NPT
Side Port 3	10° Angle	45/-	1" NPT
Side Port 4	10° x 10° Compound Angle	29/-	1" NPT

150 mm Diameter Lid - option 2

Base	Port Type	Taper Joint	Port Size
Centre Port	Vertical	34/-	1" NPT
Side Port 1	Vertical	29/-	1" NPT
Side Port 2	Vertical	29/-	1" NPT
Side Port 3	10° Angle	45/-	1" NPT
Side Port 4	10° x 10° Compound Angle	29/-	1" NPT

Contact us to discuss your requirements

To fit 200 mm ID Schott type flanges:

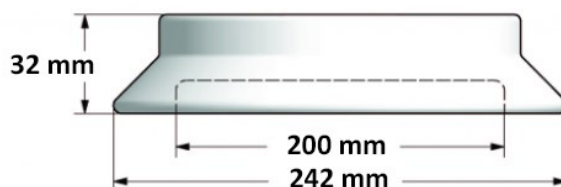

200mm Diameter Lid		- Option 1		
Base	Port Type	Taper Joint	Port Size	
Centre Port	Vertical	34/-	1" NPT	
Side Port 1	Vertical	29/-	1" NPT	
Side Port 2	Vertical	29/-	1" NPT	
Side Port 3	10° Angle	29/-	1" NPT	
Side Port 4	10° x 10° Compound Angle	29/-	1" NPT	
Side Port 5	10° Angle	45/-	1.5" NPT	
200 mm Diameter Lid		- Option 2		
Base	Port Type	Taper Joint	Port Size	
Centre Port	Vertical		1" NPT	
Side Port 1	Vertical		1" NPT	
Side Port 2	Vertical		1" NPT	
Side Port 3	10° Angle		1" NPT	
Side Port 4	10° x 10° Compound Angle		1" NPT	
Side Port 5	10° Angle		1.5" NPT	

Contact us to discuss your requirements